

# worksession #8 april 30,2009



parks

environment  
and  
sustainability

transportation  
and mobility



# worksession schedule

- april 23: summary of density, building heights and other redevelopment issues  
public facilities:  
schools  
MARC station site
- april 30: public facilities: parks  
environment and sustainability  
transportation and mobility
- may 7: design guidelines  
status of fiscal analysis and implementation
- may 21: continuation of design guidelines and land use and zoning by districts
- June 18 continuation of zoning, staging and implementation

# Park Planning & Stewardship Division

## Park Planning Recommendations White Flint Sector Plan

PARK & TRAIL PLANNING SECTION



PARK PLANNING & STEWARDSHIP



Brooke Farquhar

Montgomery County Department of Parks  
Montgomery County Planning Board Meeting

April 30, 2009



# **Park Planning Recommendations White Flint Sector Plan**

- Role of parks in the Sector Plan open space system
- Connections to parks within and beyond the Sector Plan boundary
- Park Planning Recommendations: Wall Local Park and the Civic Green Urban Park
- Potential elementary school effects on White Flint Neighborhood Park



# Role of Parks in the White Flint Open Space System

- For the Corridor: An active park for White Flint and surrounding areas at Wall Local Park
- For all of White Flint: a central civic green

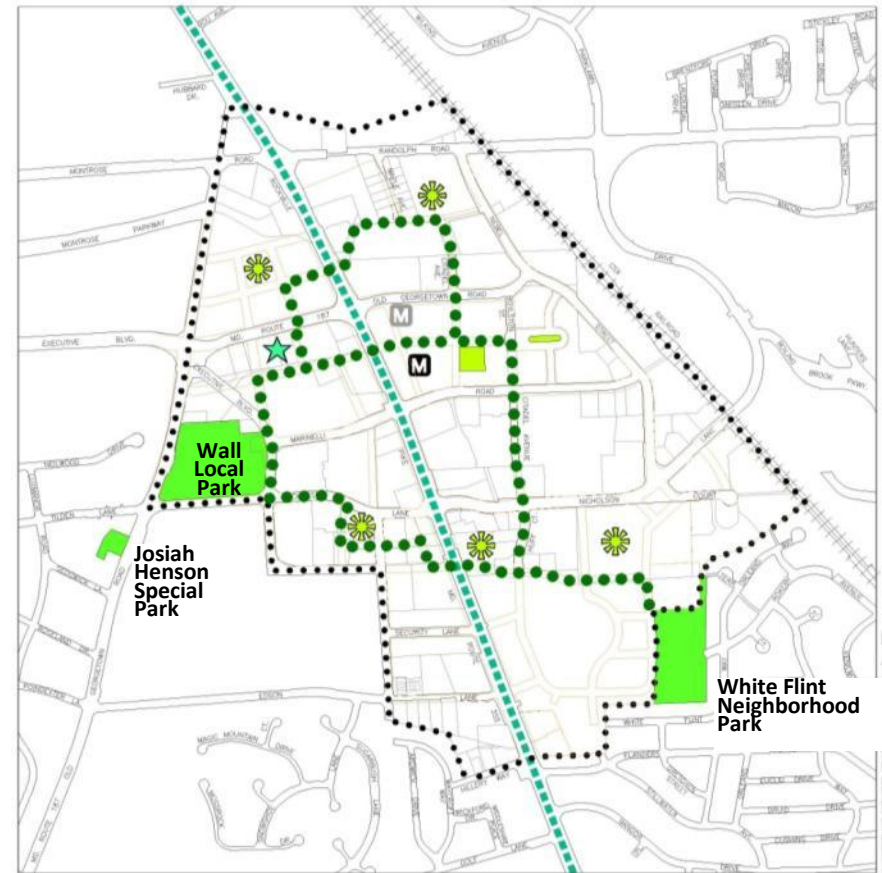

White Flint Sector Plan

Staff Draft - September 2008

# How White Flint Connects to the Regional Parks

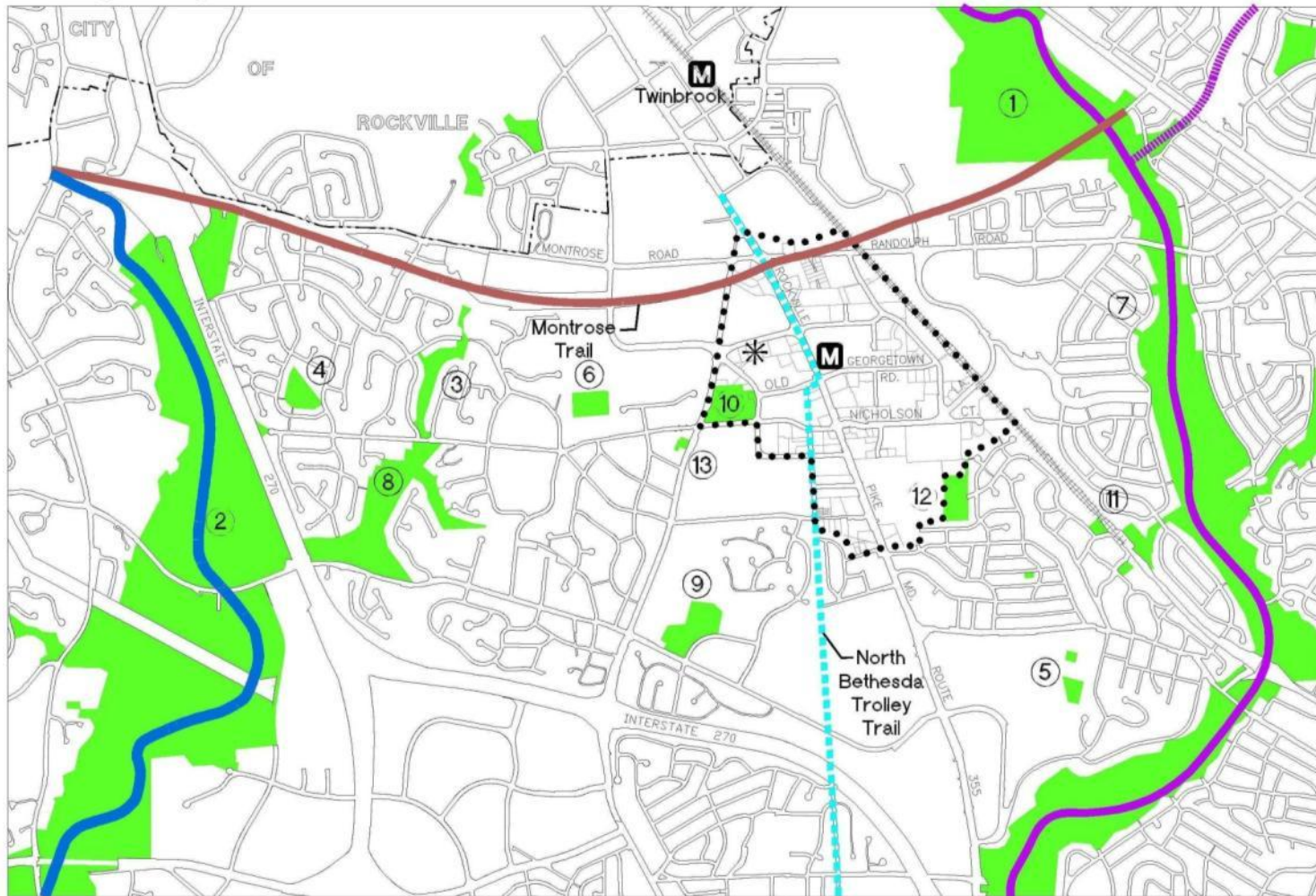

- Sector Plan Area Boundary
- M** White Flint Metro Station
- Natural Surface Trails
- Hard Surface Trails
- \* Proposed Civic Green
- ① Rock Creek Regional Park
- ② Cabin John Regional Park
- ③ Tilden Woods Stream Valley Park
- ④ Farmland Drive-LP
- ⑤ Garrett Park Estates-LP
- ⑥ Luxmanor-LP
- ⑦ Randolph Hills-LP
- ⑧ Tilden Woods-LP
- ⑨ Timberlawn-LP
- ⑩ Wall Park
- ⑪ Wells-NP
- ⑫ White Flint-NP
- ⑬ Josiah Henson Special Park





# Parks In the North Bethesda Planning Area

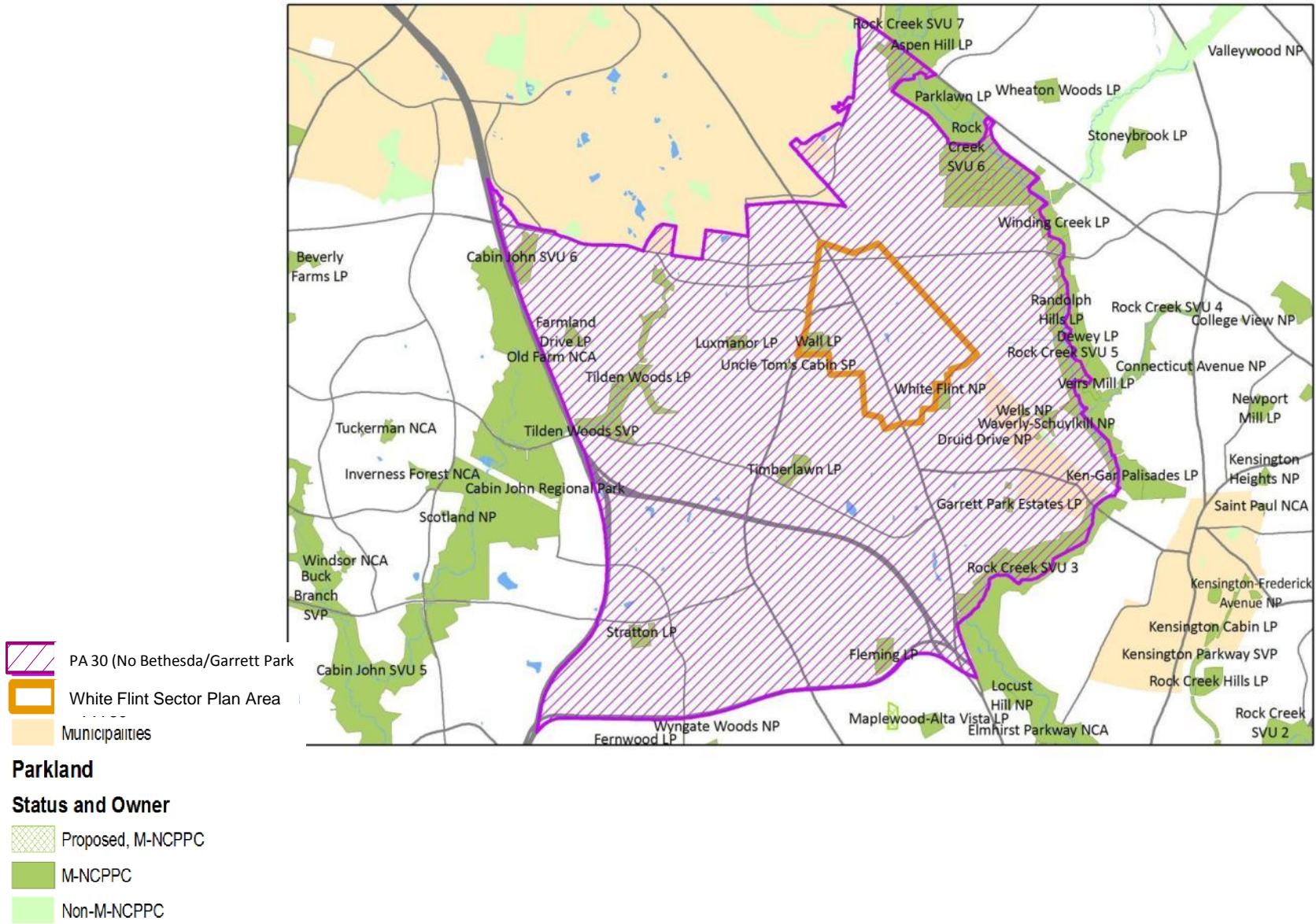

# Planning Parks in Urban Areas

- Short walking distances
- Gathering places
- Flexible recreation spaces
- Multiple users

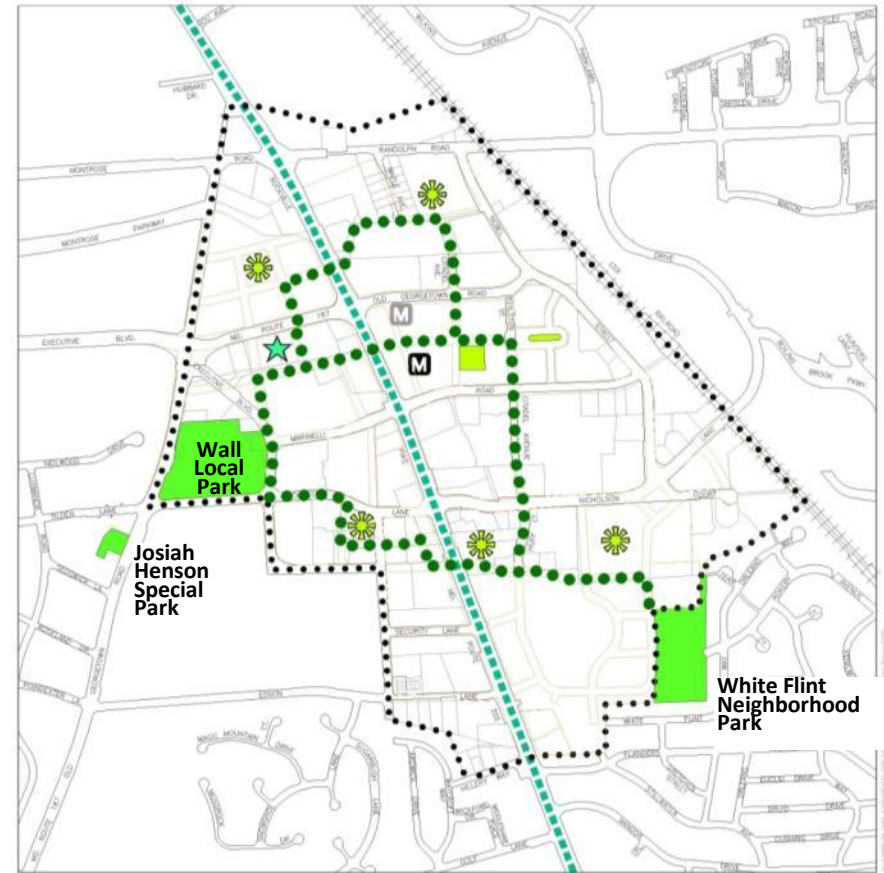

White Flint Sector Plan

Staff Draft - September 2008



# A New Civic Green Urban Park

Centrally located within  
the Conference Center  
Block

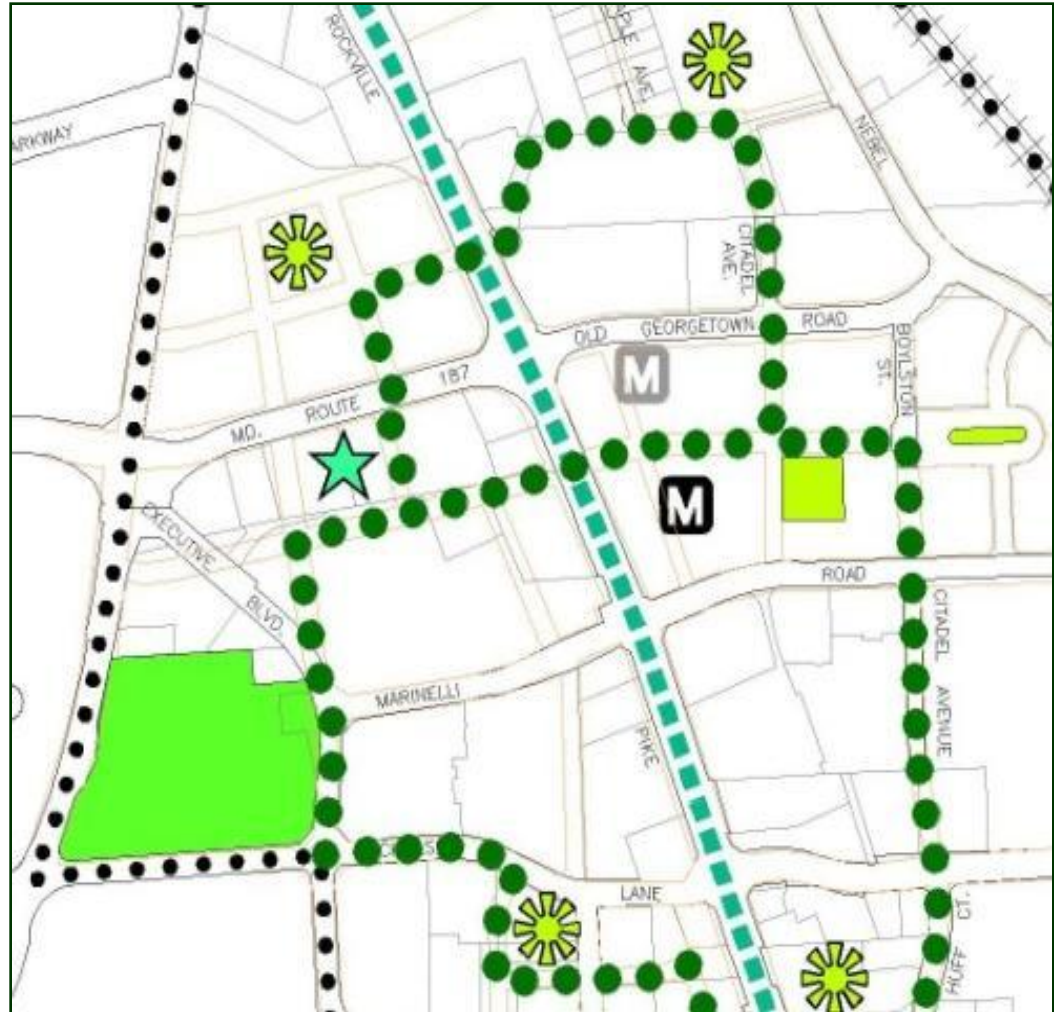

# A New Civic Green Urban Park

For outdoor community-wide activities and events



# A New Civic Green Urban Park

Implementation Options:

- Dedication, if assemblage
- Acquisition with public funds





# Wall Local Park

An active park for White Flint and surrounding areas



# Wall Local Park Today





# Wall Local Park - Implementation

- Relocate the surface parking through a partnership
- Design with public input, through facility plan process





# Wall Local Park - Vision

Active urban  
recreation  
destination



# White Flint Neighborhood Park

- 8.5 acres
- 4+ acres moderate quality urban forest, with many specimen size trees
- 30% slopes and drainage swale adjacent to school site
- 2 tennis courts, 2 basketball courts, unprogrammed open space, playground, trail

