

# *Community Facilities*

Community facilities are a major element in a community's ability to provide its residents with a desirable quality of life. Parks, open space, schools, recreational facilities, and government buildings provide focus and community identity as well as services and programs.

Like many down-County areas, Forest Glen is predominantly developed and already has a range of community facilities. (See Figure 27, page 69.) Generally, however, community facilities serving the Forest Glen area are located beyond the sector plan

area boundaries. The majority of these facilities are located in Silver Spring, approximately 1.5 miles to the south, or in Wheaton, approximately the same distance to the north.

Forest Glen residents have approximately 54 acres of parkland available to them within the sector plan area. (See Table D, page 68.) The McKenney Hills Local Park, while not within the sector area, is contiguous to the sector boundary and therefore accessible to area residents.

**Existing M-NCPPC Parkland and Facilities in the Forest Glen Sector Plan Area**

Table D

	Acreage	Basketball	Playgrounds	Shelter	Other Facilities/Comments
Forest Glen Neighborhood Park	3.6	1.0	1	1	Extensive paths and small parking area. This park in Sligo Creek Stream Valley Park Unit 4. Remainder of park to be developed in 1996. Hiker/biker trail, playfield; acreage includes only the portion of the park in the sector plan area.
Forest Grove Neighborhood Park	8.0	0.5	1		
General Getty Neighborhood Park	3.9				
Sligo Creek Stream Valley Park Unit 4	39.0		1		
<b>Total</b>	<b>54.5</b>	<b>1.5</b>	<b>3</b>	<b>1</b>	

Forest Glen is served by three public schools: Albert Einstein High School on Newport Mill Road, Sligo Middle School on Dennis Avenue, and Oakland Terrace Elementary School on Plyers Mill Road. St. John's School, a private educational institution, is located within the sector area at Woodland and August Drives.

Oakland Terrace Elementary School has recently been modernized. The school is projected to exceed its capacity in the late 1990s. Sligo Middle School is also expected to experience a small shortfall in 1998. Einstein High School is scheduled for modernization in the coming year, with completion in September 1997. This project includes an eight-room addition.

The former Forest Grove Elementary School was declared surplus by Montgomery County Public Schools (MCPS) and deeded to the County in June 1993. The County has not been selling former school buildings or sites to the private sector in recent years because rising school enrollments in some areas have required some of these schools to be reopened. The

County's leases include language requiring the leaseholder to vacate a leased building in the event that MCPS needs to reopen it as a school. The former Forest Grove Elementary School is currently leased to Holy Cross under a lease that expires in June 1997. A second lease option period, if the school continues to be available for lease, will expire in 2005.

The majority of child day care services are provided by private family day care providers and group day care center operators. Most child day care centers operate in open or closed schools and in religious institutions due to space and licensing requirements and the affordable rental rates.

Forest Glen is also the location of a private community hospital, Holy Cross, that serves as a major community landmark. Holy Cross Hospital provides a wide range of inpatient and outpatient services for the community. In addition, the organization provides community education; adult, child and rehabilitative day care; home care services; and community meeting space.

# Existing Community Facilities

Figure 27

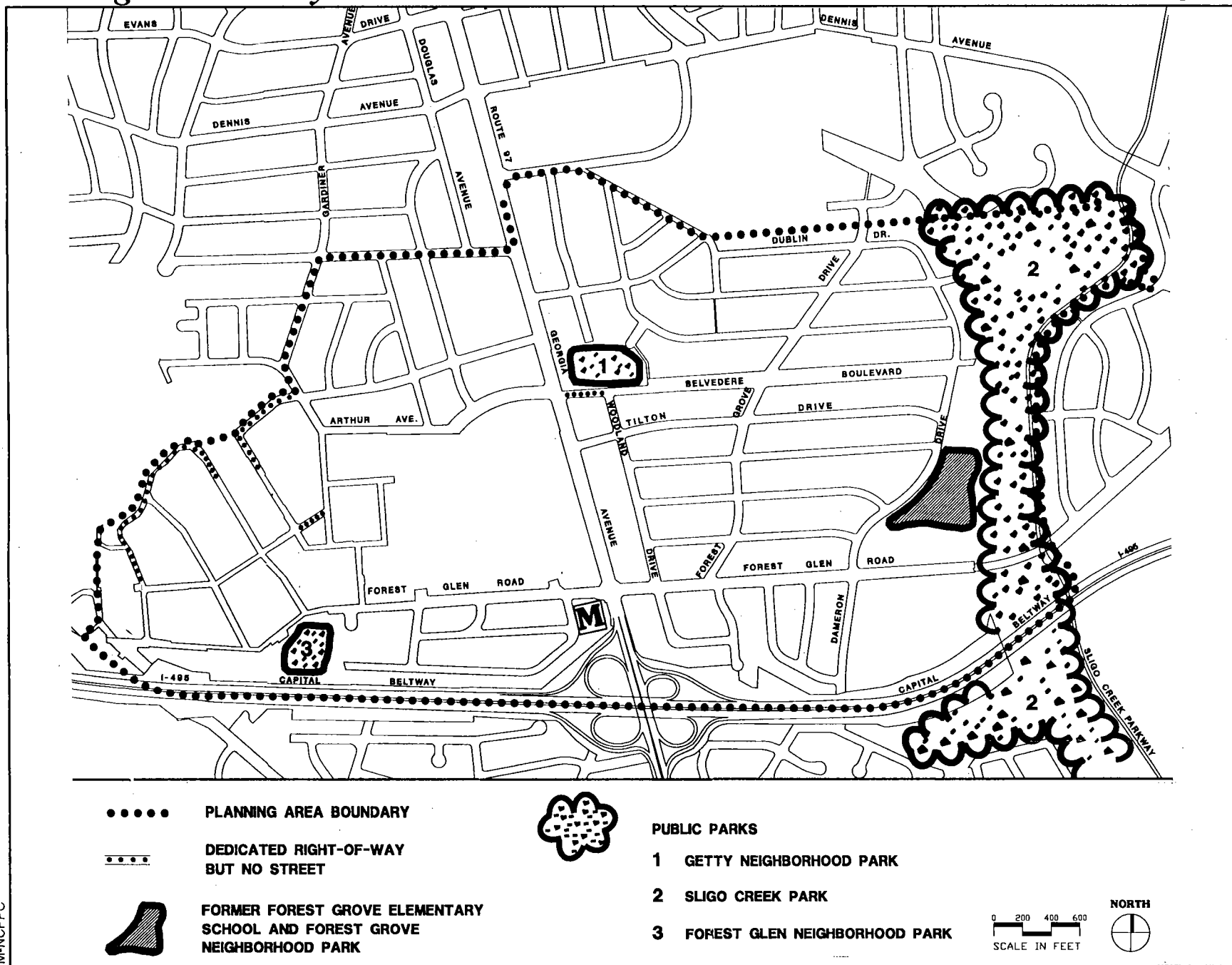

M-NCPPC

**OBJECTIVE A:**

*Provide new or expanded facilities to service new growth, if appropriate.*

- Rely on the Approved Master Plan for Educational Facilities, the annual Capital Improvements Program (CIP), and the Annual Growth Policy as statements of direction for the public school facilities in Forest Glen.

**OBJECTIVE B:**

*Acquire and maintain a system of natural areas, open spaces, and recreation facilities that are accessible to and appropriate for all area residents.*

- Rely on the *Parks, Recreation, and Open Space (PROS) Master Plan* and the annual Capital Improvements Program as statements of direction for the development of the park system in Montgomery County. No major parkland acquisitions are currently proposed in the Forest Glen Sector Plan area.
- Promote park maintenance and rehabilitation to ensure that the facilities are pleasant to use, safe, and create a favorable public image.
- Replace deteriorated facilities during major park renovations. The Parks Department should consider the age composition of nearby residents and include facilities for elderly and disabled residents when needed.
- Improve pedestrian/bike access to Sligo Creek Park by providing Class I bike paths from Sligo Creek Park to Dameron Drive (two-thirds of this path is already built) and on Forest Glen Road between the Sligo Creek Trail and Belvedere Place. (See Chapter Four.)

**OBJECTIVE C:**

*Provide expanded facilities in parts of the sector plan area that are deficient in such facilities.*

- Developable areas which may provide an opportunity for the provision of open space are the Freeman Property and the Metro parking lot.

**OBJECTIVE D:**

*Replace, recycle, enhance, or reuse facilities which are needed to meet future demands.*

- In examining the reuse of closed public school facilities, ensure that proposals are compatible with the adjoining uses and neighborhoods.

This Plan supports the continuation of the current uses in the former Forest Grove Elementary School until such time as the Board of Education may need to reclaim the facility as a school. The current uses include both adult and child day care and offices associated with Holy Cross Hospital.

- Getty Park should be enhanced as a community focal point by dedicating the adjacent Belvedere Boulevard right-of-way to the Park and by improving the pedestrian and bike linkages from the surrounding neighborhoods. The park currently has a large playground area that is, in part, being maintained by the adjacent community as part of the Adopt-a-Park program. Future development of the park, currently scheduled for completion in 1996, will include tennis courts, paths, sitting areas, playfields, and parking.